

Water pressure stabilizer #1022-01

Installation instruction

Description

The “In-Line” water pressure stabilizer protects another plumbing fixture from dangerous outlet temperature changes that can result from fluctuating Inlet pressures. This unit automatically adjusts the hot and cold inlet pressures in order to maintain a constant temperature. If either the hot or cold water supply fails for any reason, the remote pressure balancing valve will go into anti-scald mode and safely reduce the flow of water to a mere trickle, until both hot and cold water supplies are fully restored.

This product is precision engineered to provide satisfactory performance provided it is installed and operated in accordance with the recommendations contained in this installation instruction. In order to fully enjoy the comfort, safety and reliability of your “in-Line” water pressure stabilizer, please be certain to familiarize yourself with the contents of this installation instruction.

Specifications and Dimensions

Connections : G1/2" or NPT thread options
Construction: Forging Brass Body
Finish: Forged Brass/ Nickel Plated options
Max. operating pressure: 150 psi (1000 kPa)
Min. operating pressure: 3 psi (20 kPa)
Max. Static Pressure: 500 psi (3500 kPa)
Max. Hot Water Temp: 176 °F (80 °C)
Minimum Flow: 0.5 gpm (2.2 lpm)
Maximum Flow at 60 psi (420 kPa):
Checks: Integral
Shipping weight: 1.4 lbs. (0.64 kg)
Incorporates Cold water failure/ Shut down of the hot water
Comply with Standard ASSE 1066

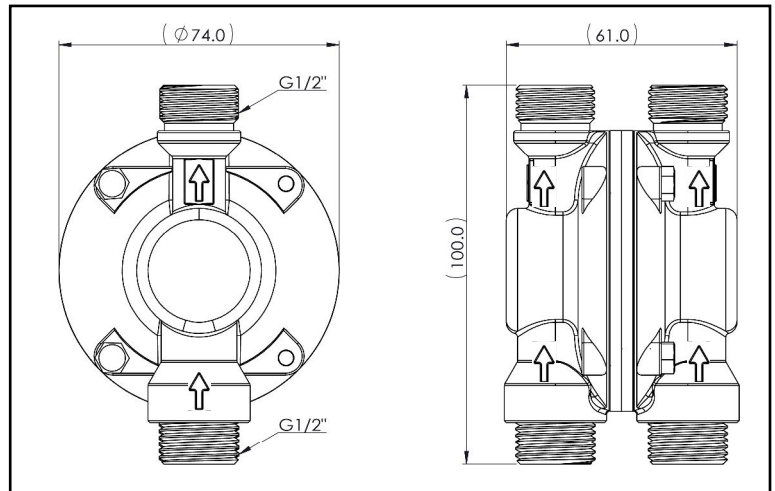

NOTE: Failure to follow these instructions may cause damage or improper operation and may void the warranty

Installation advice

- The valve can be installed vertically or horizontally and at any distance before the mixer, provided it supplies only ONE mixer and there is no additional draw-off between the pressure equalising valve and mixer.
- The valve must be positioned where it is accessible should cleaning or maintenance be necessary.
- The water heating system must be able to deliver hot water at a constant temperature, regardless of demand from the system
- The valve must be used in conjunction with shower mixers which are designed to operate on equal pressure

Caution: Use only propane or butane gas when soldering.
(Do not use oxygen/acetylene), as extreme heat may damage internal components.

Important: in order for the pressure balancing valve to function safely and correctly the hot and cold outlets must always match up with the hot and cold inlets.

